

AVAILABLE FOR SALE

601 BRUSH STREET | OAKLAND, CA



COMMERCIAL REAL ESTATE SERVICES



LISTING DATA:

- 13,600± SF on a 0.46± Acre Parcel
- Divisible into 2 Units- 8,000± SF & 5,600± SF
- Extensive Freeway Signage & Visibility
- 2,100± SF of 2nd Story Office Space
- CTU Construction
- 18'- 20' Clear Height
- 3 Roll Up Doors - 2 Oversized
- 400 Amps @ 240 Volts, 3-Phase Power
- 2" Gas Supply
- Traffic Flow - 443,000± Cars per Day
- Can Easily Divide for 2 Tenants
- Located at Intersection of Bay Bridge, 880 Hwy & 980 Hwy
- Fenced/Paved Parking Entrances on Brush & 6th
- Easy Access to I-880, Port of Oakland, San Francisco, Downtown Oakland, & Jack London
- Zoned CC-2 Community Commercial
- Unit A: 5,600± SF - Can be Delivered Vacant at Close
- Unit B: 8,000± SF - Leased through 1/31/2023
- Sale Price: \$4,012,000

DO NOT DISTURB TENANTS - CALL TO ARRANGE A TOUR

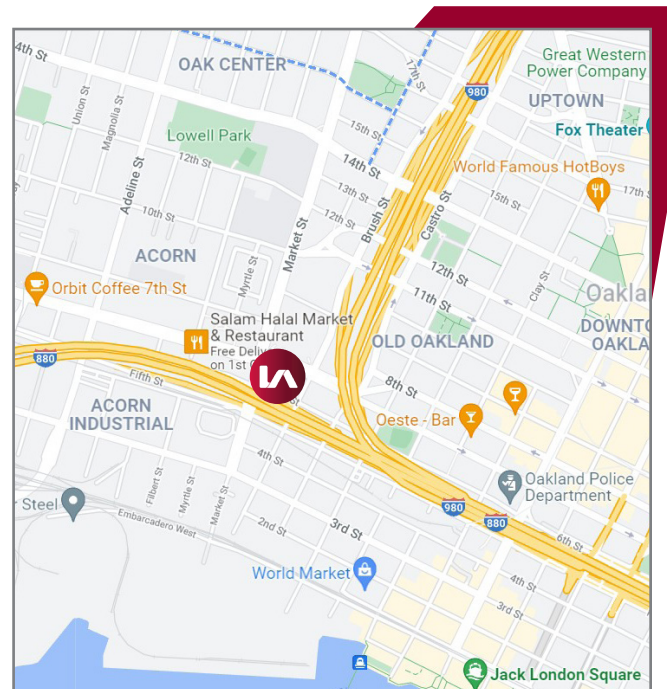

EXCLUSIVE AGENTS:

Craig Hagglund, SIOR

E \\ chagglund@lee-associates.com

P \\ 510.903.7611 | LIC# 01090730

Ryan Davidson, Principal

E \\ rdavidson@lee-associates.com

P \\ 510.469.3300 | LIC# 01400582

Drew Fischer, Principal

E \\ dfischer@lee-associates.com

P \\ 510.903.7602 | LIC# 01344242

Lee & Associates Oakland Commercial Real Estate | 520 3rd Street, Suite 105, Oakland, CA 94607 | www.lee-associates.com

All information furnished regarding property for sale, rental or financing is from sources deemed reliable, but no warranty or representation is made to the accuracy thereof and same is submitted to errors, omissions, change of price, rental or other conditions prior to sale, lease or financing or withdrawal without notice. No liability of any kind is to be imposed on the broker herein.

AVAILABLE FOR SALE

601 BRUSH STREET | OAKLAND, CA

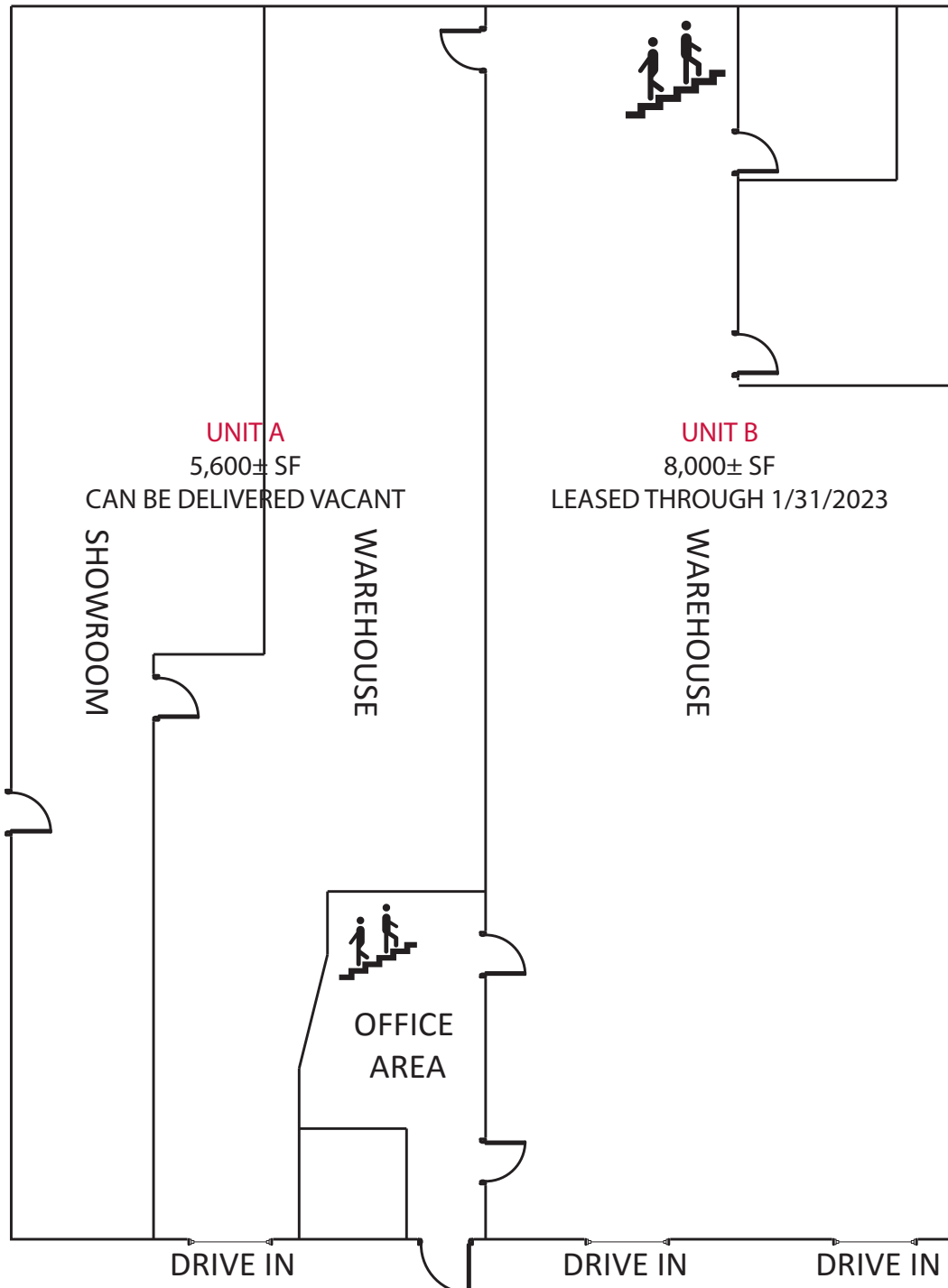

EXCLUSIVE AGENTS:

Craig Hagglund, SIOR

E \\ chagglund@lee-associates.com

P \\ 510.903.7611 | LIC# 01090730

Ryan Davidson, Principal

E \\ rdavidson@lee-associates.com

P \\ 510.469.3300 | LIC# 01400582

Drew Fischer, Principal

E \\ dfischer@lee-associates.com

P \\ 510.903.7602 | LIC# 01344242