



SOIL EXPLORATION COMPANY, INC.

Soil Engineering, Environmental Engineering, Materials Testing, Geology

December 16, 2019

Project No. 13167-01

TO: West Coast Hotels Group LLC
19215 Wild Mustang Ct.
Apple Valley, CA 92307

ATTENTION: Hitesh Patel

SUBJECT: California Building Code (CBC) 2016 Seismic Update, Proposed 8.8±Acre, 14 Lot Residential Subdivision, SEC Victoria Avenue and La Sierra Avenue, City of Riverside, California

REFERENCES: Soil Exploration Co., Inc., "Preliminary Geotechnical Investigation/Liquefaction Evaluation/Infiltration Tests Report, Proposed 8.8± Acre, 14 Lot Residential Subdivision, SEC of Victoria Avenue and La Sierra Avenue (APN 136-220-016), City of Riverside, California", Dated January 24, 2014 (Project No. 13167-01).

Introduction

As requested, we have prepared the following updated seismic parameters for the subject site.

CBC 2016 Seismic Parameters

The CBC (2016) seismic parameters for the site are tabulated below:

2016 CBC – SEISMIC PARAMETERS		
Site Coordinates	Latitude	Longitude
	33.8875	-117.4619
Mapped Spectral Response Acceleration	$S_s = 1.500$	$S_1 = 0.600$
Site Coefficients (Class "D")	$F_a = 1.00$	$F_v = 1.50$
Maximum Considered Earthquake (MCE) Spectral Response Acceleration	$S_{MS} = 1.500$	$S_{M1} = 0.900$
Design Spectral Response Acceleration Parameters	$S_{DS} = 1.000$	$S_{D1} = 0.600$
Seismic Design Category	D	
Peak Ground Acceleration (PGA)	0.514g	

References:

- Earthquake.usgs.gov/research/hazmaps/design
- 2016 California Building Code, California Code of Regulations, Title 24, Part 2, Volume 2 of 2, Section 1613, Earthquake Loads

Foundation Plan Review/Additional Observations and Testing

Soil Exploration Co., Inc. should review the foundation plans and observe and/or test at the following stages of construction:

- During any additional grading or fill placement.
- Following footings excavation and prior to placement of footing materials.
- During all utility trench backfills and street subgrade/base compaction.
- Following wetting of slab subgrade (1.2X optimum to a depth of at least 6") and prior to placement of slab materials.
- When any unusual conditions are encountered.

Limitation

Soil Exploration Co., Inc. has striven to perform our services within the limits prescribed by our client, and in a manner consistent with the usual thoroughness and competence of reputable soils engineers practicing under similar circumstances. No other representation, express or implied, and no warranty or guarantee is included or intended by virtue of the services performed or reports, opinion, documents, or otherwise supplied.

Closure

If you should have any questions regarding this report, please do not hesitate to contact our office. We appreciate this opportunity to be of service.

Very truly yours,
Soil Exploration Co., Inc.



Gene K. Luu, PE 53417
Project Engineer

Distribution: [1] Addressee (hitesh@westcoasthotelsgroup.com)

Attachments: Figure 1 Site Location Map

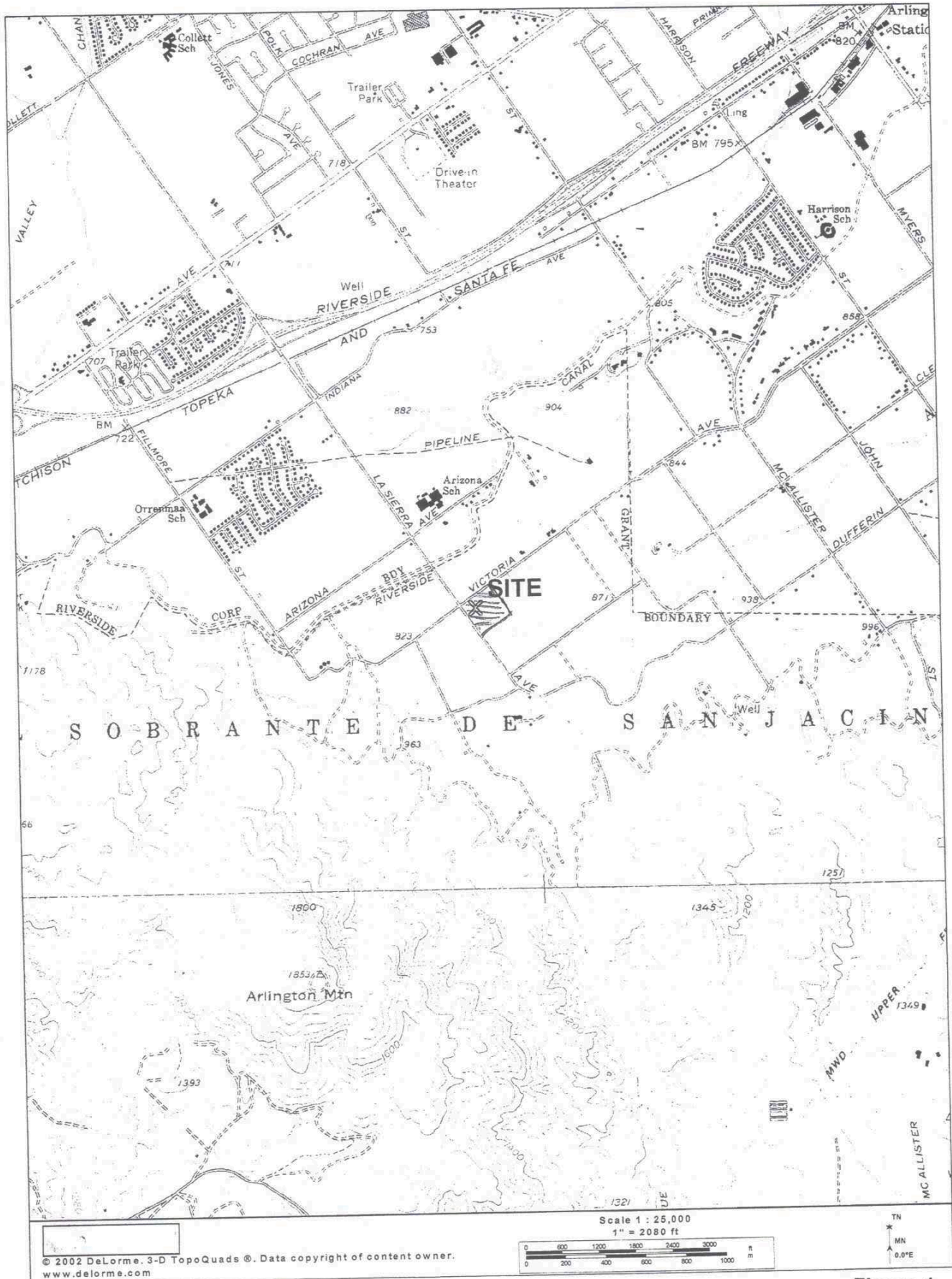

Figure 1