

FOR LEASE

---

**2393**  
**NEWTON AVE**  
Suite B, San Diego, CA 92113

**12,051 SF**  
**INDUSTRIAL SUITE**





# Property Features

# 2393



<b>PROPERTY ADDRESS</b>	2393 Newton Avenue, Suite B, San Diego, CA 92113
-------------------------	---

<b>SUITE SIZE</b>	12,051 SF
-------------------	-----------

<b>OFFICE SF</b>	2,000 SF
------------------	----------

<b>LOADING</b>	3 Grade Level Doors
----------------	---------------------

<b>CLEAR HEIGHT</b>	24'
---------------------	-----

<b>POWER</b>	600 amps, 277/480v
--------------	--------------------

<b>SPRINKLERS</b>	0.33/3,000 GPM
-------------------	----------------

<b>PARKING</b>	37 On-Site Spaces
----------------	-------------------

<b>ZONING</b>	Barrio Logan Plan District B (Industrial)
---------------	---

<b>AVAILABLE</b>	Immediately
------------------	-------------

<b>LEASE RATE</b>	\$1.40/SF GROSS
-------------------	-----------------

Second Floor

● = Grade Level Door

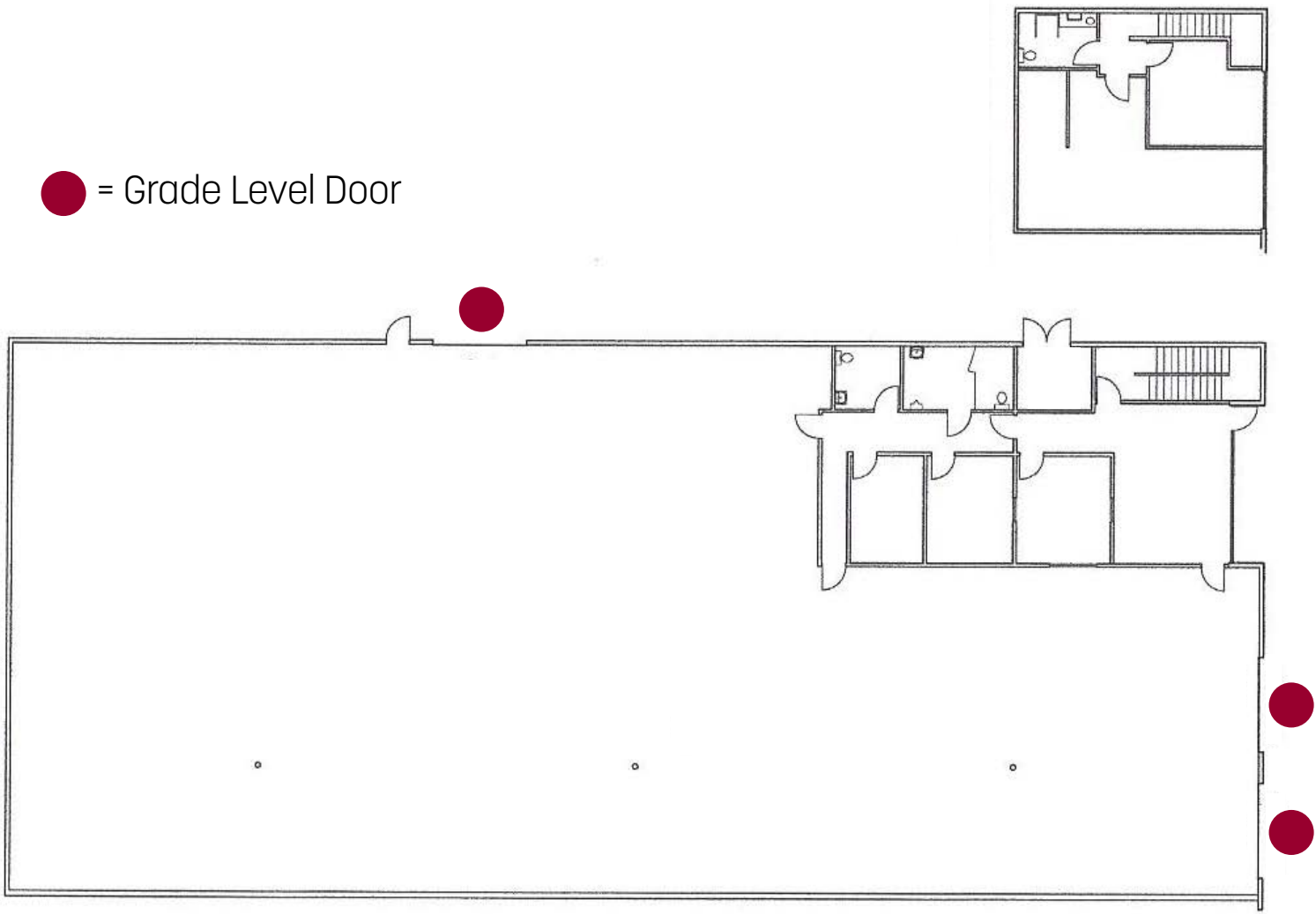







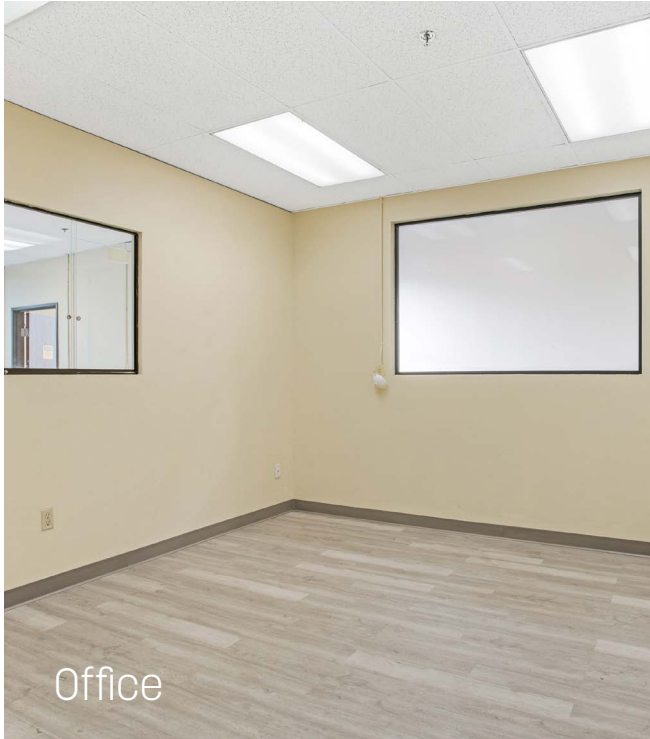

Office



Warehouse



Second Floor Office



Lobby



# Location Overview

2393



**BAE SYSTEMS**

**GENERAL DYNAMICS**  
nassco

**2393**  
NEWTON AVE







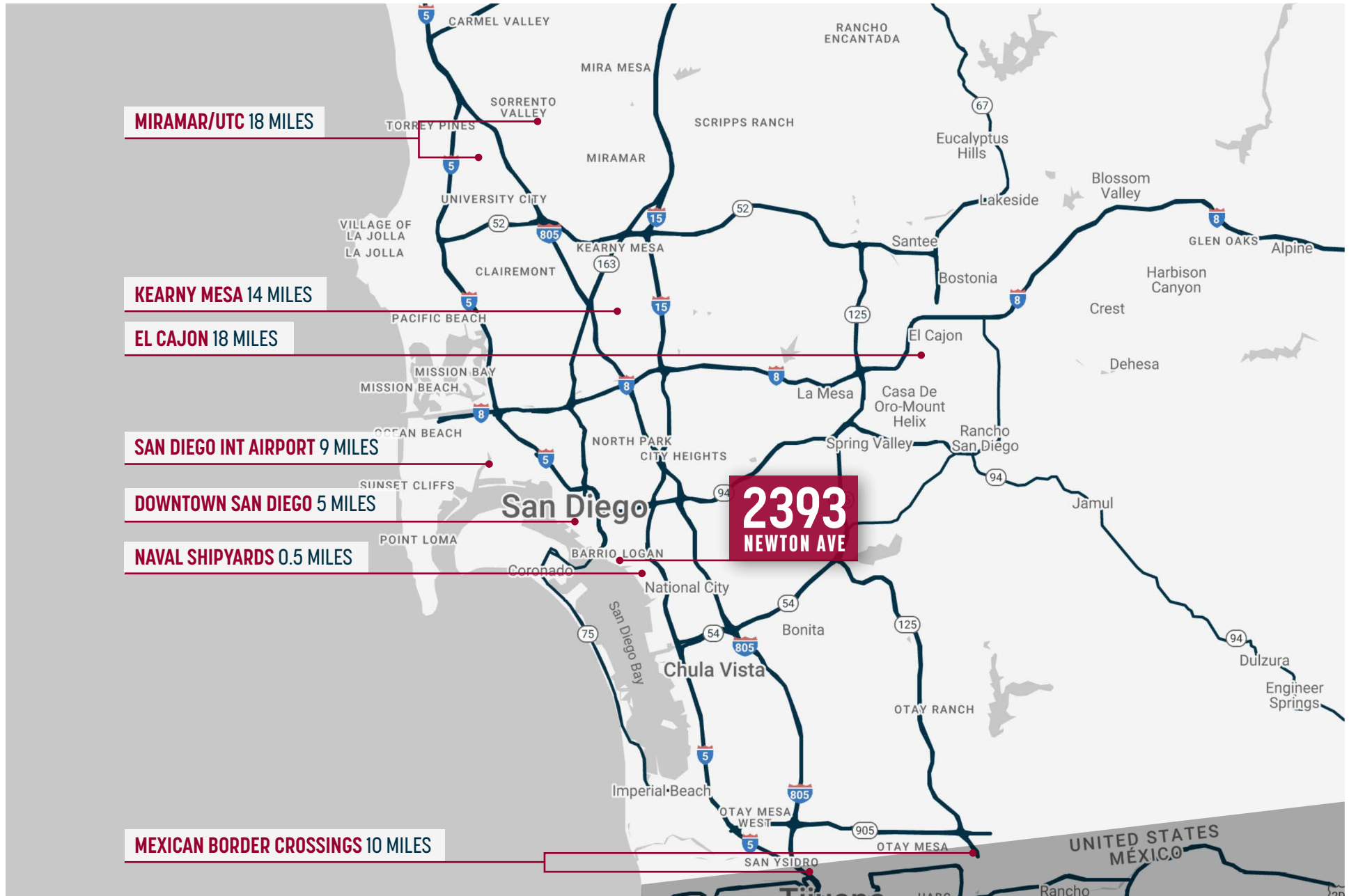

# SAN DIEGO



POPULATION  
**3.29M**



MEDIAN HOUSEHOLD  
INCOME  
**\$104,321**



UNEMPLOYMENT  
RATE  
**5.2%**

San Diego County is one of the nation's most desirable places to live, well known for its amazing year round weather and 70 miles of coastline. The region is situated in southwestern California with the Pacific Ocean to the West, Los Angeles, Orange, and Riverside Counties to the North, and the Tijuana/Mexico border to the South. In 2018, over 35 million visitors were captivated by the region's luxurious hotels, sandy beaches, fine dining establishments, world renowned golf courses, and various top attractions.



**2** Sports Teams



**6** Universities



**400** Parks & Beaches



**100+** Attractions



**6,000+** Restaurants



**70°** Average Temperature



**115+** Breweries  
*& growing!*



**70** Miles of Coastline



**75%** of the year is sunny





# 2393 | NEWTON AVE

Suite B, San Diego, CA 92113

Andrew Kenny  
(760) 929-7841  
akenny@lee-associates.com  
DRE Lic#02206475

Rusty Williams, SIOR  
(760) 448-2453  
rwilliams@lee-associates.com  
DRE Lic#01390702

Chris Roth, SIOR  
(760) 448-2448  
croth@lee-associates.com  
DRE Lic#01789067

Jake Rubendall, SIOR  
(760) 448-1369  
jrubendall@lee-associates.com  
DRE Lic#02037365



Lee & Associates Commercial Real Estate Services, Inc. - NSDC | 1902 Wright Place, Suite 180, Carlsbad, CA 92008 | P: (760) 929-9700 | F: (760) 929-9977 | [www.lee-associates.com/sandiegonth](http://www.lee-associates.com/sandiegonth)

No warranty or representation is made to the accuracy of the foregoing information. Terms of sale or lease and availability are subject to change or withdrawal without notice.

Any of the foregoing information will need to be separately verified by Buyer.

Vista Demographics Source: [www.datausa.io](http://www.datausa.io); Photo Source for 'Vista' page: Wikimedia Commons